

Stainless Processing, Inc.

Coatesville, PA

Ph: 800-345-8126 Fax: 610-384-7362

150 lb. BLIND PLATE FLANGES

- For Pipe and Tube
- OD AND DRILLING for ½" through 24" pipe size's per ASME / ANSI B16.5-1996 Class 150
- OD AND DRILLING for 30" & 36" pipe size per ASME / ANSI B16.1-1989 Class 125
- Dimensions are given in inches

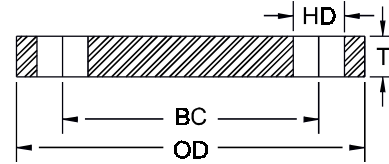

NOMINAL PIPE SIZE	THICKNESS (T)	OUTSIDE DIA. (OD)	NUMBER OF HOLES	HOLE DIA. (HD)	BOLT CIRCLE (BC)	SHIPPING WEIGHT IN POUNDS
½	.500	3.50	4	.62	2.38	1.26
¾	.500	3.88	4	.62	2.75	1.59
1	.500	4.25	4	.62	3.12	1.95
1¼	.500	4.62	4	.62	3.50	2.34
1½	.500	5.00	4	.62	3.88	2.77
2	.500	6.00	4	.75	4.75	3.99
2½	.500	7.00	4	.75	5.50	5.53
3	.500	7.50	4	.75	6.00	6.38
3½	.500	8.50	8	.75	7.00	8.00
4	.500	9.00	8	.75	7.50	9.04
5	.500	10.00	8	.88	8.50	11.10
6	.500	11.00	8	.88	9.50	13.58
8	.500	13.50	8	.88	11.75	20.81
10	.750	16.00	12	1.00	14.25	42.75
12	.750	19.00	12	1.00	17.00	61.15
14	.750	21.00	12	1.12	18.75	74.60
16	.750	23.50	16	1.12	21.25	93.21
18	1.000	25.00	16	1.25	22.75	139.62
20	1.000	27.50	20	1.25	25.00	168.71
24	1.000	32.00	20	1.38	29.50	229.49
30	1.250	38.75	28	1.38	36.00	418.77
36	1.500	46.00	32	1.62	42.75	701.78

Notes:

This table is intended for estimating purposes only. Applications vary, confirm all dimensions with your engineering department prior to ordering. Refer to ASME B16.5-1996 and B16.1-1989 standard for complete engineering and applications information. All dimensions are in inches unless otherwise noted. Thickness dimension is application specific. Recommended bolts are 1/8" smaller in diameter than the bolt hole diameters shown.